

Zhangzhou Jialong Technology Inc.

Add: Beidou Industry Park, Zhangzhou City, Fujian, China
www.jialong.cn sales01@jialong.cn Tel: 86 13605051800



JL1120 Continuous Sealer



Product

Details;

1, JL1120 can seal all kinds of heat sealable materials, which adopts constant temperature control system and stepless speed adjusting transmission mechanism.

2, Both temperature and height of conveyor table are adjustable.

3, The machine

works with solid-ink coder to print the colored labels while sealing.

4, They are able to print at high speed with instant dry and highly legible letters that have a good adhesion property.

5, The height of both seal head and conveyor table are adjustable to accommodate a wide range of applications.

6, It can also be integrated into the production line.

Zhangzhou Jialong Technology Inc.

Add: Beidou Industry Park, Zhangzhou City, Fujian, China
www.jialong.cn sales01@jialong.cn Tel: 86 13605051800



Parameters:

	JL1120
Voltage (V/Hz)	AC 220/50 110/60
Motor Power (W)	245
Sealing Power (W)	300x2
Printing Heating Power(W)	40x2
Speed(m/min)	0-10
Seal Width(mm)	10
Temperature Range(°C)	0-300
Printing Type	Solid-Ink Roller
Distance from Sealing Center to Conveyor (mm)	100-700
Conveyor Size(LxW)(mm)	1400x250
Max. Conveyor Load for Single Bag(kg)	5
Overall Conveyor Load(kg)	15
External Dimensions(LxWxH) (mm)	1450x680x1480
Net Weight (kg)	136

Dimension:

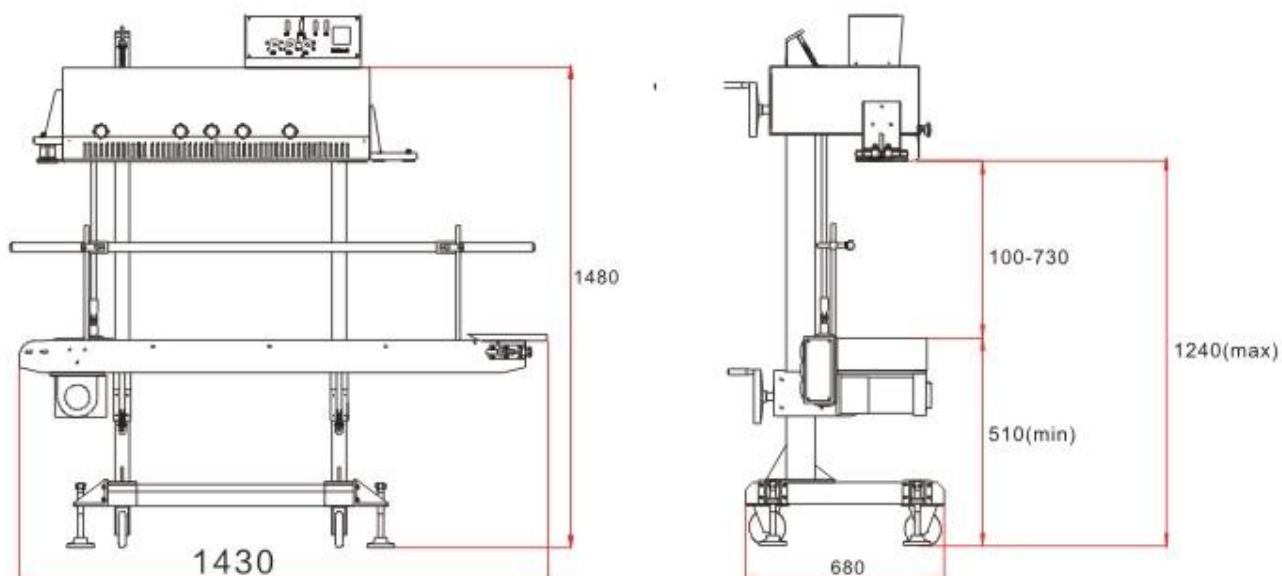

Zhangzhou Jialong Technology Inc.

Add: Beidou Industry Park, Zhangzhou City, Fujian, China
www.jialong.cn sales01@jialong.cn Tel: 86 13605051800



Machine sectional details:

